

CARACTERISTICAS / FEATURES

Material hormigón petra 1
Acabado decapado e hidrofugado
Dimensiones l. 200, a. 60, h. 54 cm
Color ver carta de colores
Fijación mediante resina epoxi
Peso 700 kg
Palet 200 x 80 x 70 cm
Peso palet 715 kg

Material precast concrete petra 1
Finish scaled and waterproofed
Dimensions l. 200, a. 60, h. 54 cm
Colour see colour catalogue
Fixing anchored with epoxy resin
Weight 700 kg
Palette 200 x 80 x 70 cm
Weight palette 715 kg

diseñador / design: Oriol Pardo

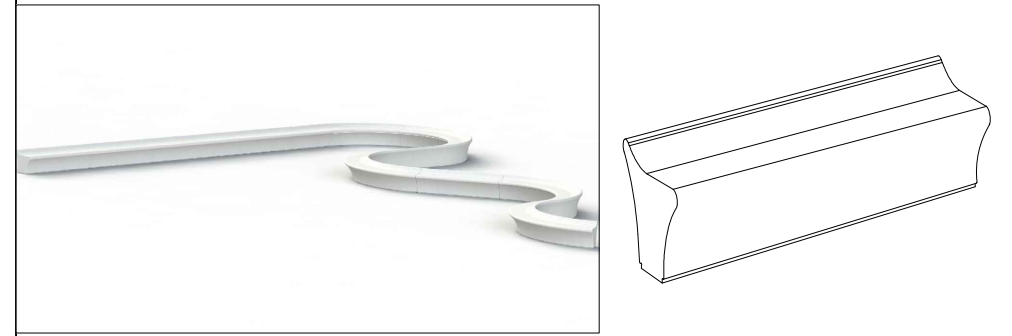

GEOMETRIA / GEOMETRY

- A barra corrugada / corrugated rod
- B casquillo roscado / threaded sleeve
- C cáncamo / eyebolt
- D tapa / stopper

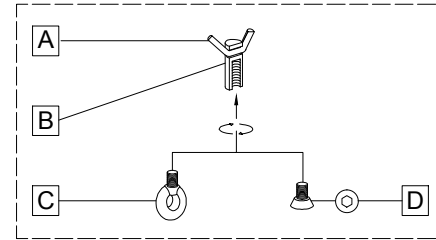

SISTEMA DE ELEVACION / LIFTING SYSTEM

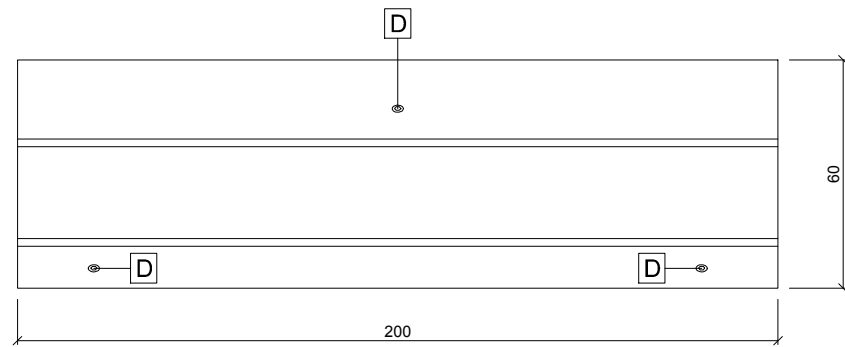

VISTA INFERIOR / BOTTOM VIEW

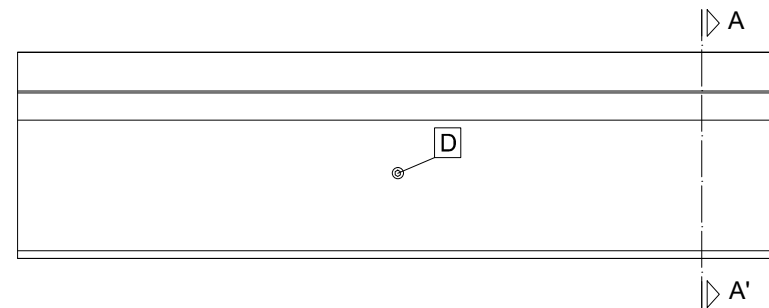

ALZADO / FRONT VIEW

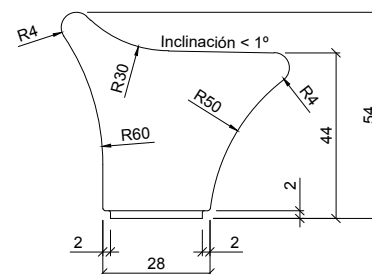

PERFIL / PROFILE

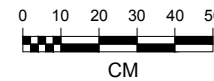

MANIPULACION E INSTALACION / HANDLING AND INSTALLATION

1 Extraer tapa / Extract stopper

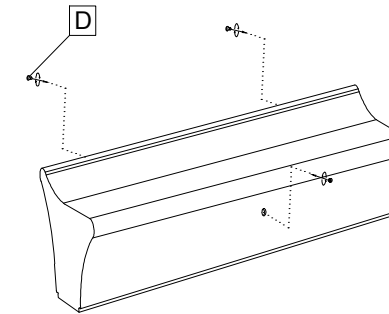

2 Enroscar cáncamo / Thread the eyebolt

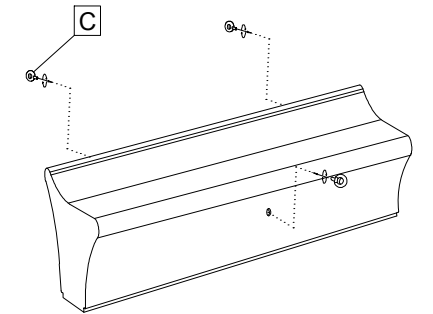

3 Verter resina epoxi / Pour epoxy resin

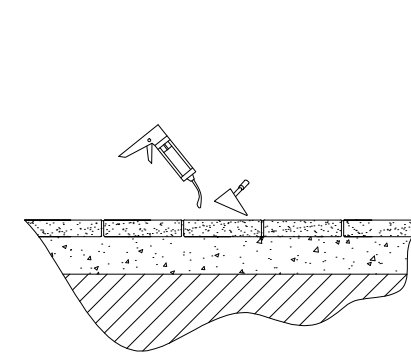

4 Elevar e instalar / Lift and install

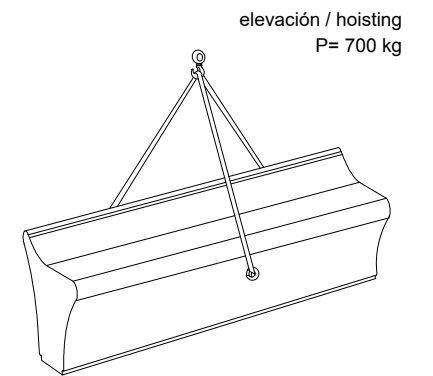

elevación / hoisting
P= 700 kg

ESPECIFICACIONES / SPECIFICATIONS

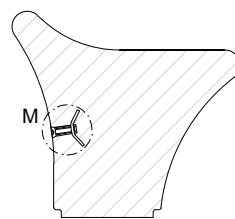

SECCION A-A' / SECTION A-A'

B Casquillo M16 acero zincado alta precisión
Galvanized steel pipe M16 high precision

Barra corrugada acero negro Ø10
Corrugated black steel rod Ø10 A

D Tapa - Tornillo avellanado M16 · A2
Stopper - Countersunk screw M16 · A2

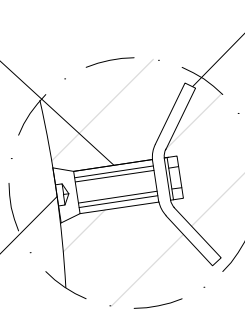

DETALLE M / DETAIL M