

CARACTERISTICAS / FEATURES



Material hormigón Petra 1
Acabado decapado e hidrofugado
Dimensiones l. 120, a. 120, h. 80 cm
Color ver carta de colores
Fijación apoyado por su propio peso o mediante resina epoxi
Peso 940 kg / 620 L
Palet 130 x 130 cm

Material precast concrete Petra 1
Finish scaled and waterproofed
Dimensions l. 120, w. 120, h. 80 cm
Colour see colour catalogue
Fixing resting on the ground or with epoxy resin
Weight 940 kg / 620 L
Pallet 130 x 130 cm

diseñador / design: Ton Riera

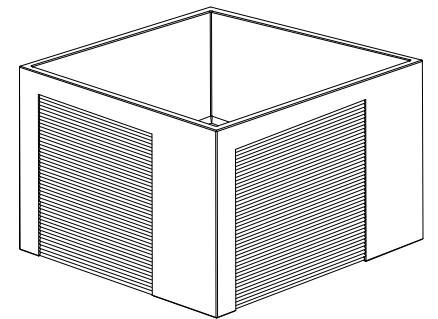

TANIT SM

GEOMETRIA / GEOMETRY

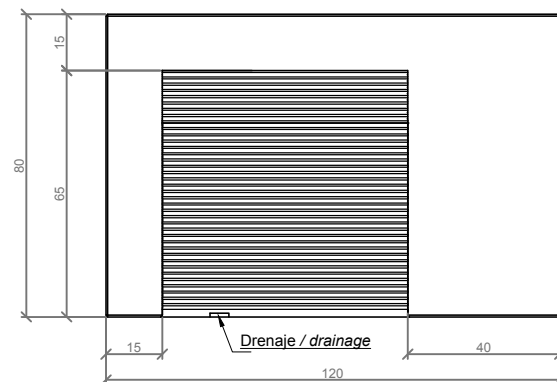

ALZADO / FRONT VIEW

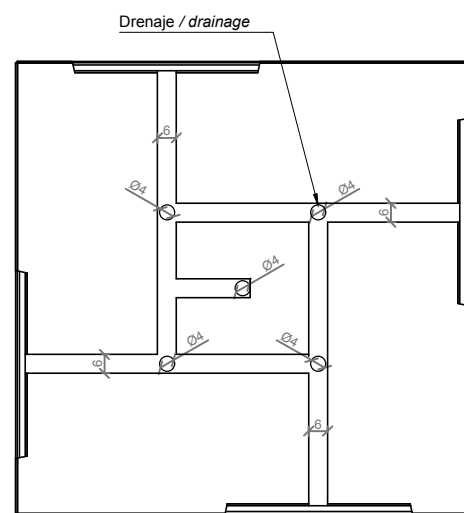

VISTA INFERIOR / BOTTOM VIEW

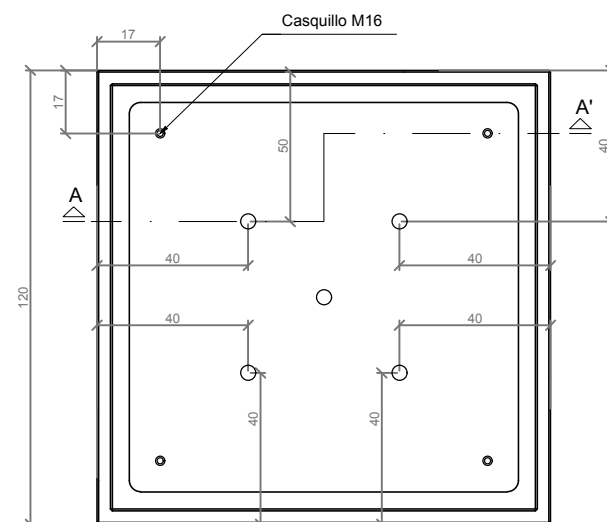

PLANTA / TOP VIEW

ESC. 1:20

MANIPULACION E INSTALACION / HANDLING AND INSTALLATION

- 1 Enroscar cáncamo al casquillo roscado
 Thread the eyebolt on the threaded sleeve

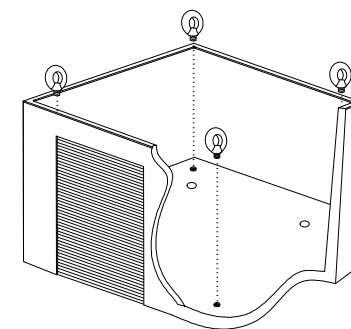

- 2 Elevar mediante eslingas / Lifting with slings

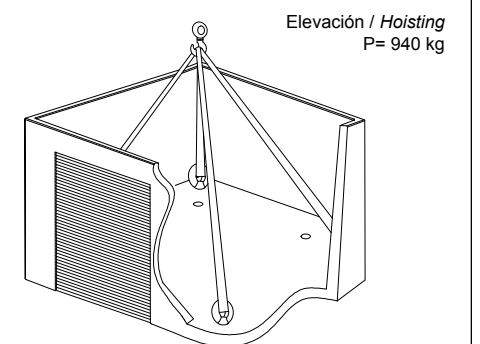

- 3 Verter resina epoxi / Pour resin epoxy

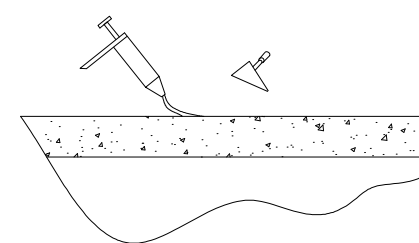

- 4 Instalar sobre la resina epoxi / Install over resin epoxy

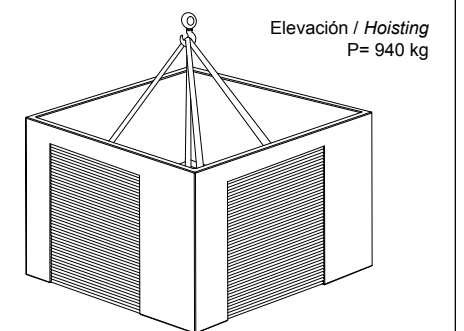

ESPECIFICACIONES / SPECIFICATIONS

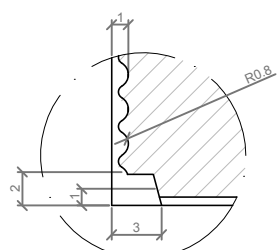

DETALLE N / DETAIL N

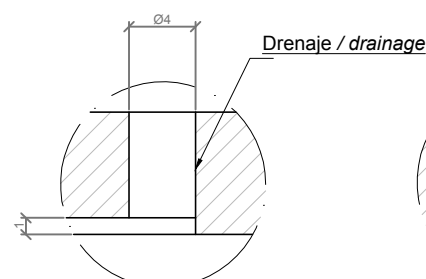

DETALLE M / DETAIL M

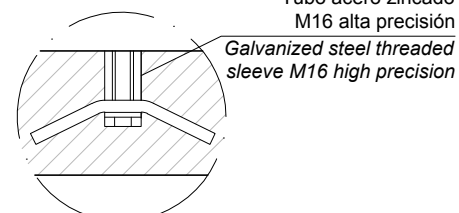

DETALLE C / DETAIL C

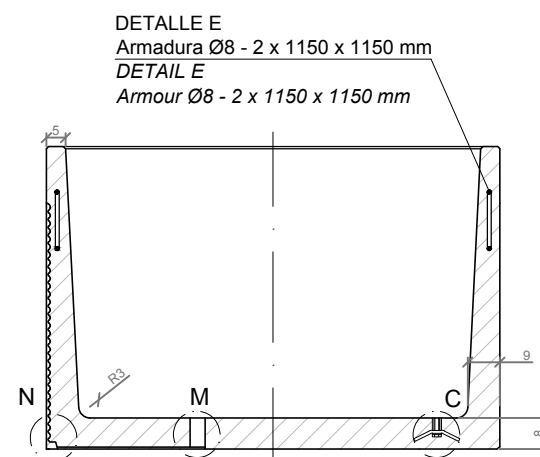

SECCION A-A' / SECTION A-A'

DETALLE E
 Armadura Ø8 - 2 x 1150 x 1150 mm
 DETAIL E
 Armour Ø8 - 2 x 1150 x 1150 mm

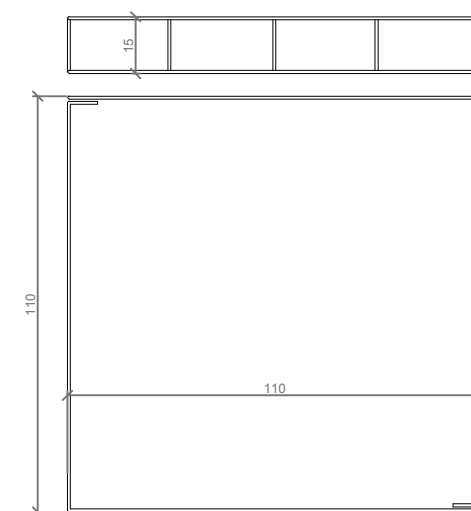

ALZADO DETALLE E
 ALZADO DETAIL E

PLANTA DETALLE E
 PLANTA DETAIL E