

**CARACTERÍSTICAS / FEATURES**

**Material** hormigón Petra1  
**Acabado** decapado e hidrofugado  
**Dimensiones** l. 55, a. 55, h. 97 cm  
**Color** ver carta de colores  
**Fijación** simplemente apoyado  
**Peso / Capacidad** 345 Kg / 65L  
**Palet** 120 x 110 x 120 cm [4u]  
**Peso palet** 1405 Kg

**Material** precast concrete Petra1  
**Finish** scaled & waterproofed  
**Dimensions** l. 55, w. 55, h. 97 cm  
**Colour** see colour catalogue  
**Fixing** resting on the ground  
**Weight / Capacity** 345 Kg / 65 L  
**Package** 120 x 110 x 120 cm [4u]  
**Weight pallet** 1405 Kg

diseñador / design: I+D mago:urban



**GEOMETRIA / GEOMETRY**

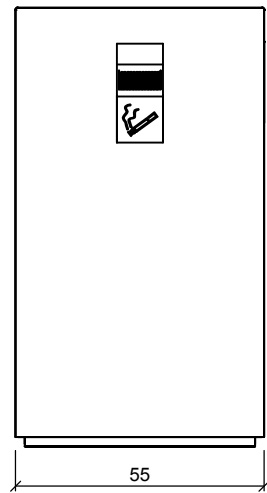

ALZADO

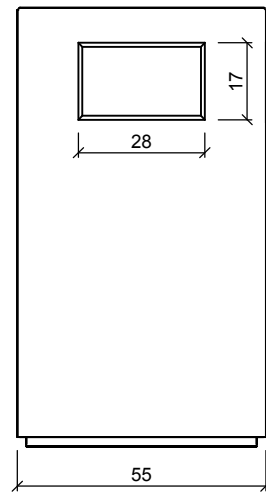

PERFIL

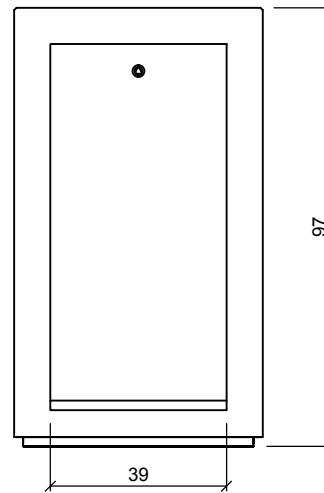

VISTA POSTERIOR



PLANTA



ESCALA EN CM

**ESPECIFICACIONES / SPECIFICATIONS**

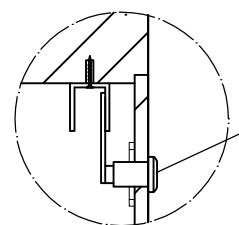

DETAIL

Cerramiento de llave triangular  
 Triangular key closure

Chapa raspadora de acero inoxidable  
 Scraper stainless steel sheet

Recipiente para colillas de aluminio  
 Aluminum container for cigarette butts

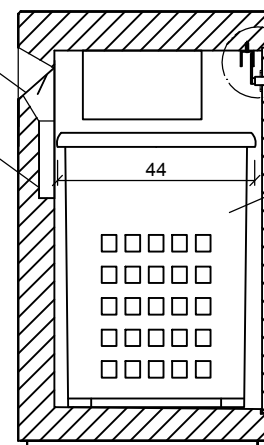

SECTION

Puerta de acceso  
 Access door

Recipiente de basura  
 trash receptacle

Perfil de acero inoxidable  
 Stainless steel profile

**MANIPULACIÓN E INSTALACIÓN / HANDLING AND INSTALLATION**

