

CARACTERISTICAS / FEATURES

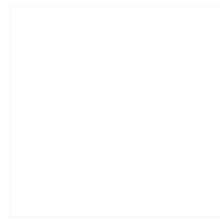

Material hormigón Petra 1
Acabado decapado e hidrofugado
Dimensiones l. 200, a. 80, h. 48 cm
Color ver carta de colores
Fijación apoyado por su propio peso o mediante resina epoxi
Peso 700 kg
Palet 210 x 90 cm

Material precast concrete Petra 1
Finish scaled and waterproofed
Dimensions l. 200, w. 80, h. 48 cm
Colour see colour catalogue
Fixing resting on the ground or with epoxy resin
Weight 700 kg
Pallet 210 x 90 cm

diseñador / design: magourban

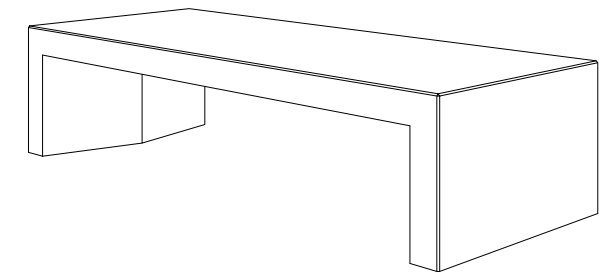

TARGA B

GEOMETRIA / GEOMETRY

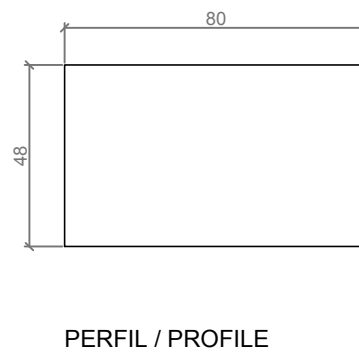
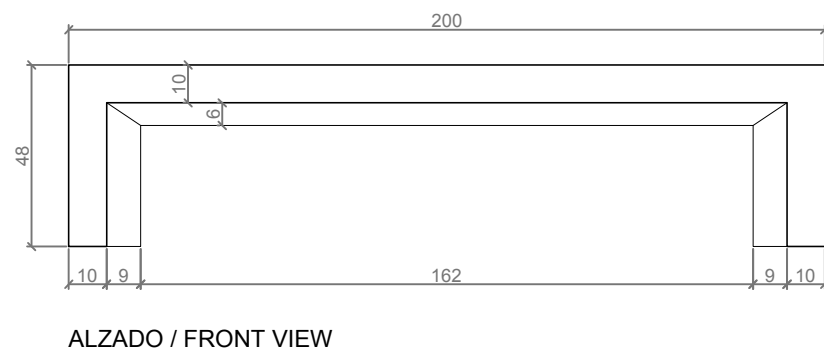
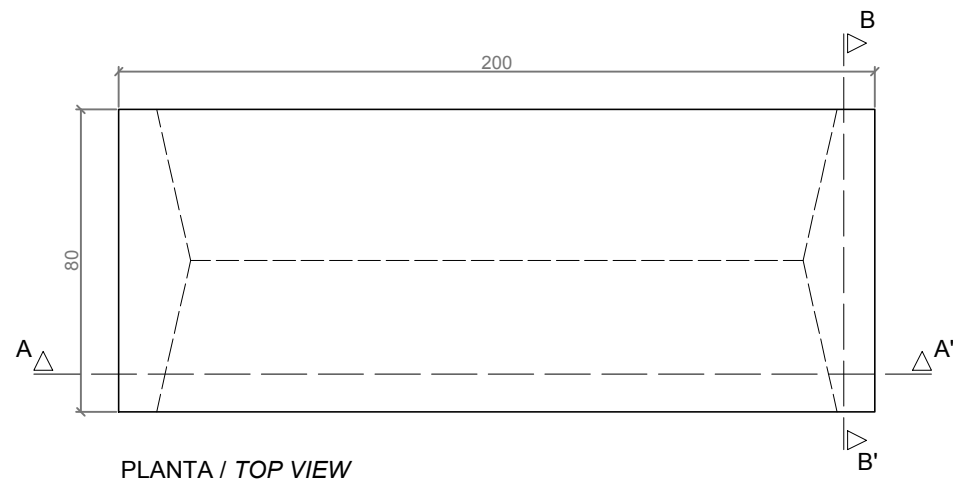

ESCALA / SCALE 1/20

MANIPULACION E INSTALACION / HANDLING AND INSTALLATION

- 1 Elevar y enroscar varillas inferiores
Lifting and screwing lower rods

MUY IMPORTANTE / VERY IMPORTANT
 Proteger las esquinas con espuma del embalaje
 Protect the corners with packing foam

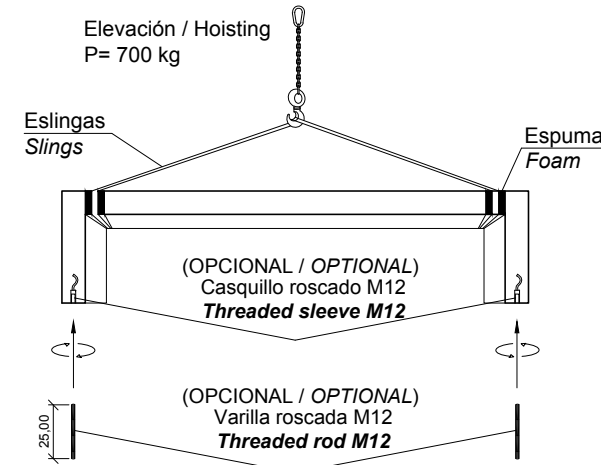

- 3 Verter resina epoxi
Pour epoxy resin

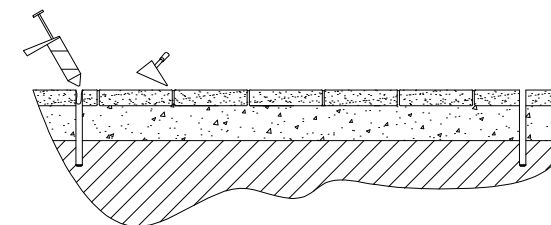

- 2 Perforar agujeros de Ø1,4 cm
Drill holes of Ø1.4 cm

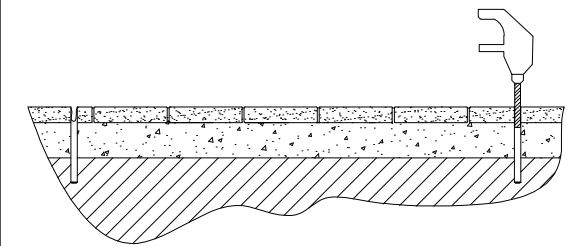

- 4 Insertar las varillas M12 en los agujeros
Insert metal rods M12 in holes

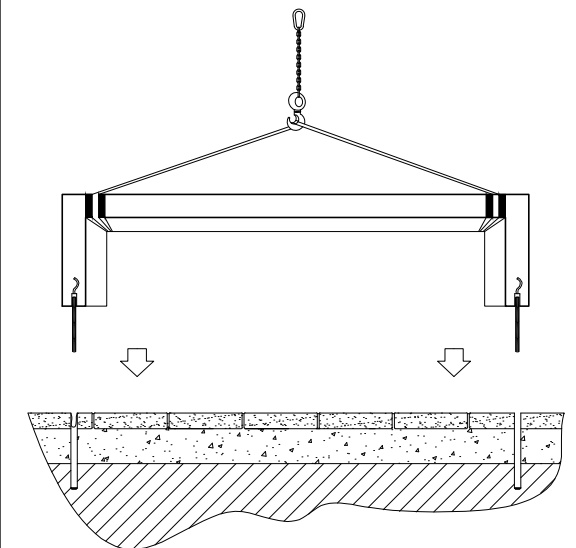

ESPECIFICACIONES / SPECIFICATIONS

Detalle D, OPCIONAL
 (Instalación con varilla metálica)
 Detail D (OPTIONAL)
 (Installation with metal rod)



Casquillo M12 - Acero zincado alta precisión
 Threaded sleeve M12 - Galvanized steel high precision

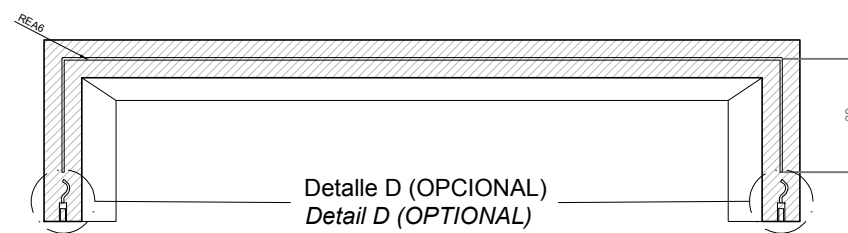

Malla electrosoldada con barra de Ø6 mm cada 150 mm
 Electrically welded grating rods of Ø6 mm each 150 mm

