

**CARACTERISTICAS / FEATURES**

**Material** hormigón petra 1  
**Acabado** decapado e hidrofugado  
**Dimensiones** l. 160, a.40,2, h. 49,6 cm  
**Color** ver carta de colores  
**Fijación** simplemente apoyado o mediante varillas metálicas  
**Peso** 400 kg  
**Palet** 200 x 80,4 x 65 cm  
**Peso palet** 430 kg

**Material** concrete petra 1  
**Finish** scaled and waterproofed  
**Dimensions** l. 160, w. 40.2, h. 49.6 cm  
**Colour** see colour catalogue  
**Fixing** resting on the ground or anchored with metal rod  
**Weight** 400 kg  
**Pallet** 200 x 80.4 x 65 cm  
**Weight pallet** 430 kg

diseñador / design: EMBT, Benedetta Tagliabue

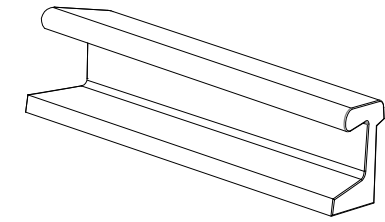

**GEOMETRIA / GEOMETRY**

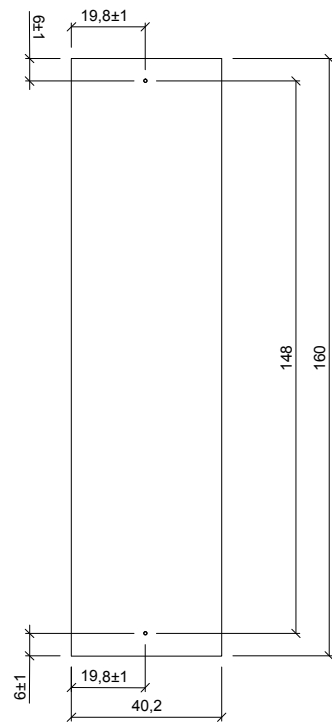
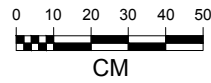

VISTA INFERIOR / BOTTOM VIEW

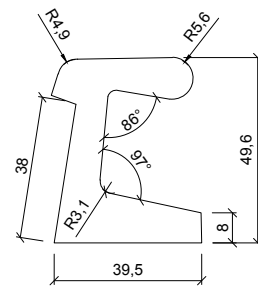

ALZADO / FRONT VIEW

**ESPECIFICACIONES / SPECIFICATIONS**

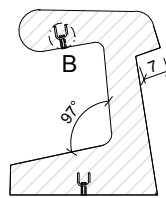

SECCION 1 / SECTION 1

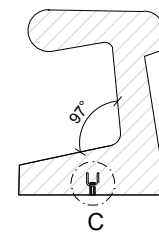

SECCION 2 / SECTION 2

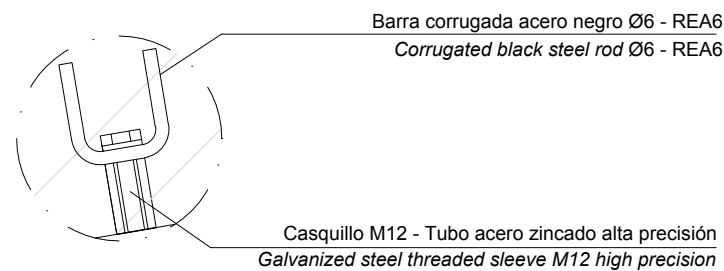

DETALLE B / DETAIL B  
 [ELEVACION / HOISTING]

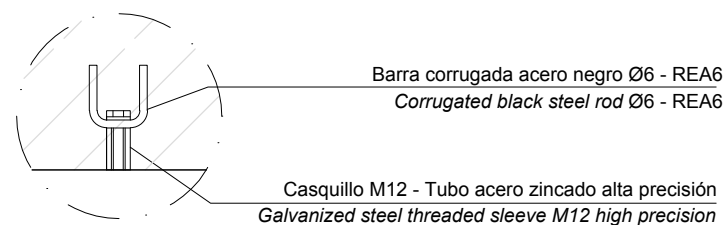

DETALLE C / DETAIL C  
 [ANCLAJE / ANCHORAGE]

**MANIPULACION E INSTALACION / HANDLING AND INSTALLATION**

- 1 Enroscar cáncamo, elevar y enroscar la varilla  
 Thread the eyebolt, lift and thread the rod

elevación / hoisting  
 P= 400 kg

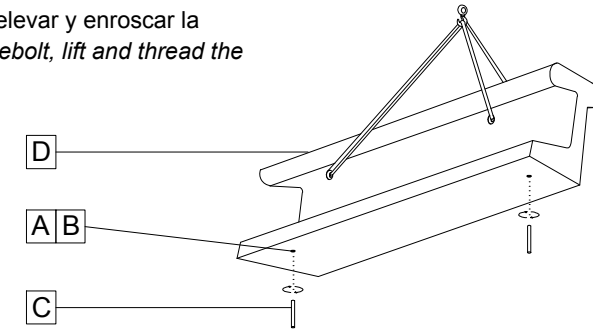

SISTEMA DE ELEVACION / ANCHORAGE SYSTEM

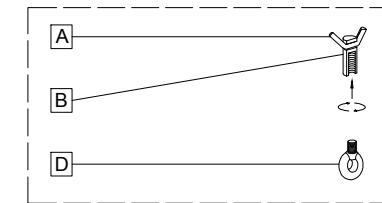

- A barra corrugada / corrugated rod
- B casquillo roscado / threaded sleeve
- D cáncamo / eyebolt

SISTEMA DE FIJACION / LIFTING SYSTEM

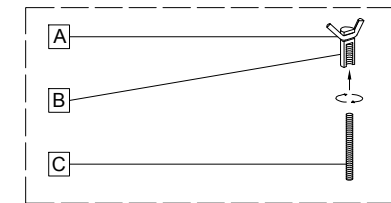

- A barra corrugada / corrugated rod
- B casquillo roscado / threaded sleeve
- C varilla roscada / threaded rod

- 2 Perforar 2 agujeros a distancia ± 147,6 cm  
 Drill 2 holes each at a distance ± 147.6 cm
- 3 Verter resina epoxi / Pour epoxy resin



- 4 Insertar la varilla en el agujero  
 Insert metal rod in hole

