

**CARACTERISTICAS / FEATURES**

**Material** hormigón Petra1  
**Acabado** decapado e hidrofugado  
**Dimensiones** l. 55, a. 55, h. 97 cm  
**Color** ver carta de colores  
**Fijación** simplemente apoyado  
**Peso / Capacidad** 350 kg / 65L  
**Palet** 120 x 110 x 120 cm [4u]  
**Peso palet** 1415 kg

**Material** precast concrete Petra1  
**Finish** scaled & waterproofed  
**Dimensions** l. 55, w. 55, h. 97 cm  
**Colour** see colour catalogue  
**Fixing** resting on the ground  
**Weight / Capacity** 350 kg / 65 L  
**Pallet** 120 x 110 x 120 cm [4u]  
**Weight pallet** 1415 kg

diseñador / design: I+D magourban



**GEOMETRIA / GEOMETRY**

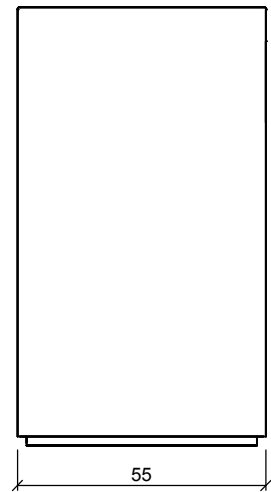

ALZADO

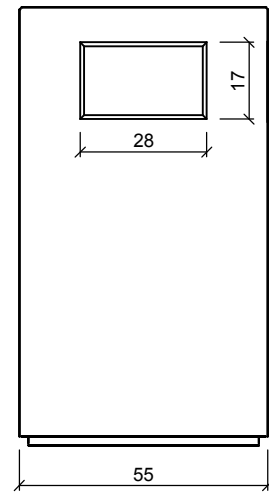

PERFIL

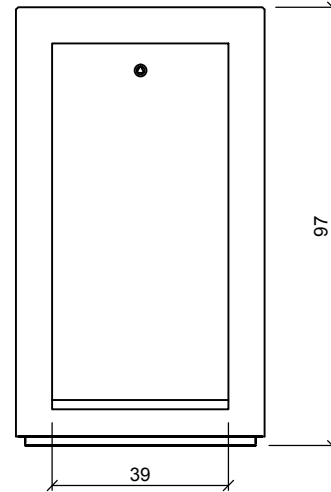

VISTA POSTERIOR



PLANTA

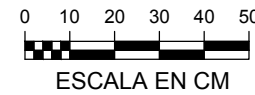

ESCALA EN CM

**ESPECIFICACIONES / SPECIFICATIONS**

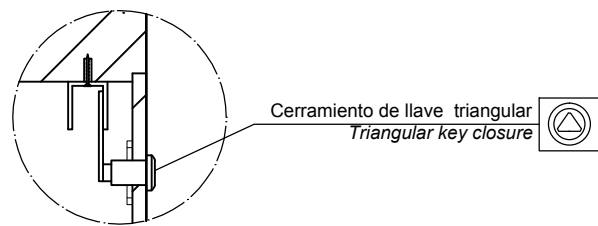

DETAIL

Cerramiento de llave triangular  
 Triangular key closure

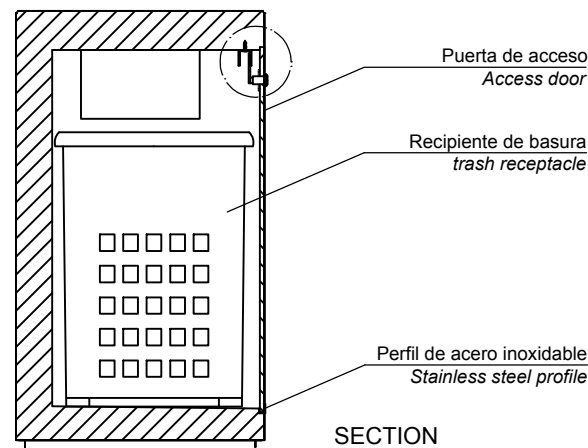

SECTION

Puerta de acceso  
 Access door

Recipiente de basura  
 trash receptacle

Perfil de acero inoxidable  
 Stainless steel profile

**MANIPULACION E INSTALACION / HANDLING AND INSTALLATION**

Verter resina epoxi  
 Pour epoxy resin

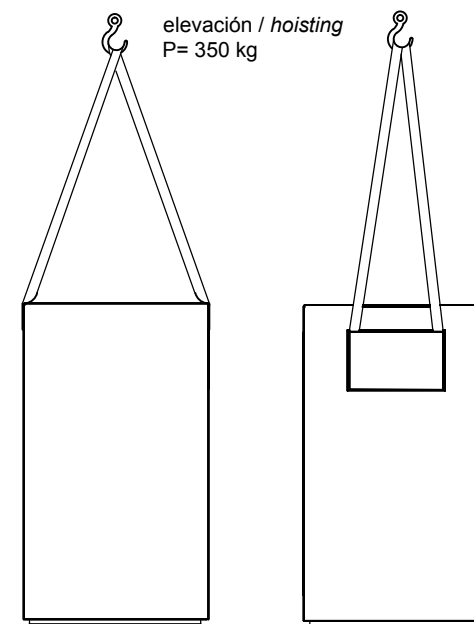
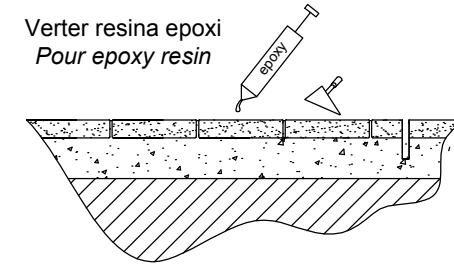

elevación / hoisting  
 P= 350 kg

